

# Optical Fiber Distribution Frame

## GPX82-5

### Overview

LongXing optical fiber distribution frame GPX82-5 is made of top quality steel and deformed aluminum alloy and treated with galvanizing, oxidation and electrostatic plastic spraying, and it has the advantages of anti-corrosion, solid structure and pleasing appearance.

### Features

- There are 19" mounting rails in the middle of the frame for installing ODFs
- Available color: white, black, grey or any other colors on request.
- All the plastic elements in the frame are fire-resistant meets UL-94.
- Reliable cable fixture cover and earth protection device/ grounding system provided.
- A sticky label with the warning "Caution laser radiation" will be stuck to the frame.
- Enough space for fiber distribution and storage space and very easy for installation and operation.
- Fully front side operation, convenient for maintenances.
- Minimum bend radius is controlled of 30mm.
- Cable guides mounted on right side of canal are removable and relocatable to different positions within the same vertical line, to ensure a minimum bend radius of 30mm for the patch cords from any ODFs.
- There are two lateral canals with separate doors (on left and right side of the frame) for distribution and management of fiber optical cables;
- The side-hinged doors help to well protect the patch cords distribution area.
- The optical cable inlet system is installed on the top or bottom of the frame which has excellent performances for fixing the incoming cables.
- Cables can be entered to the frame either from top or the bottom of the frame subject to different requirements.
- This Frame is suitable for both bundle (loose) cables and ribbon type cables.

Dimensions and Capability			
Dimensions (H*W*D)mm	Capacity (SC)	Capacity (LC)	ODU-L10-4U
2,200*900*300	864	1728	Max. 9 units

\*Customized designs are available upon request

### Optional Elements

- Hardware to fasteners, and fastening to the number of fiber needed can be offered on request.
- Elements to protect buffers depending on the number of cables needed can be offered on request.
- Accessories such as screws, nut, fasteners for raiser floor or concrete floor can be offered on request.
- Customer's logo can be printed on the upper left corner or upper right corner of the frame on request.

Operation Conditions	
Temperature	-5℃ -- 60℃
Humidity	90% at 30℃
Air Pressure	70kPa – 106kPa

Shipping Information	
Package Contents	ODF 1 unit
Package Dimensions(W*H*D)	It depends on the dimensions of the product
Material	wooden box
Weight	It depends on the dimensions of the product
Lead Time	10-15 working days normally

**Part Details** (for reference only, actual product is subject to final drawings)



Front view with door closed



Front view with door open



Back view with door closed

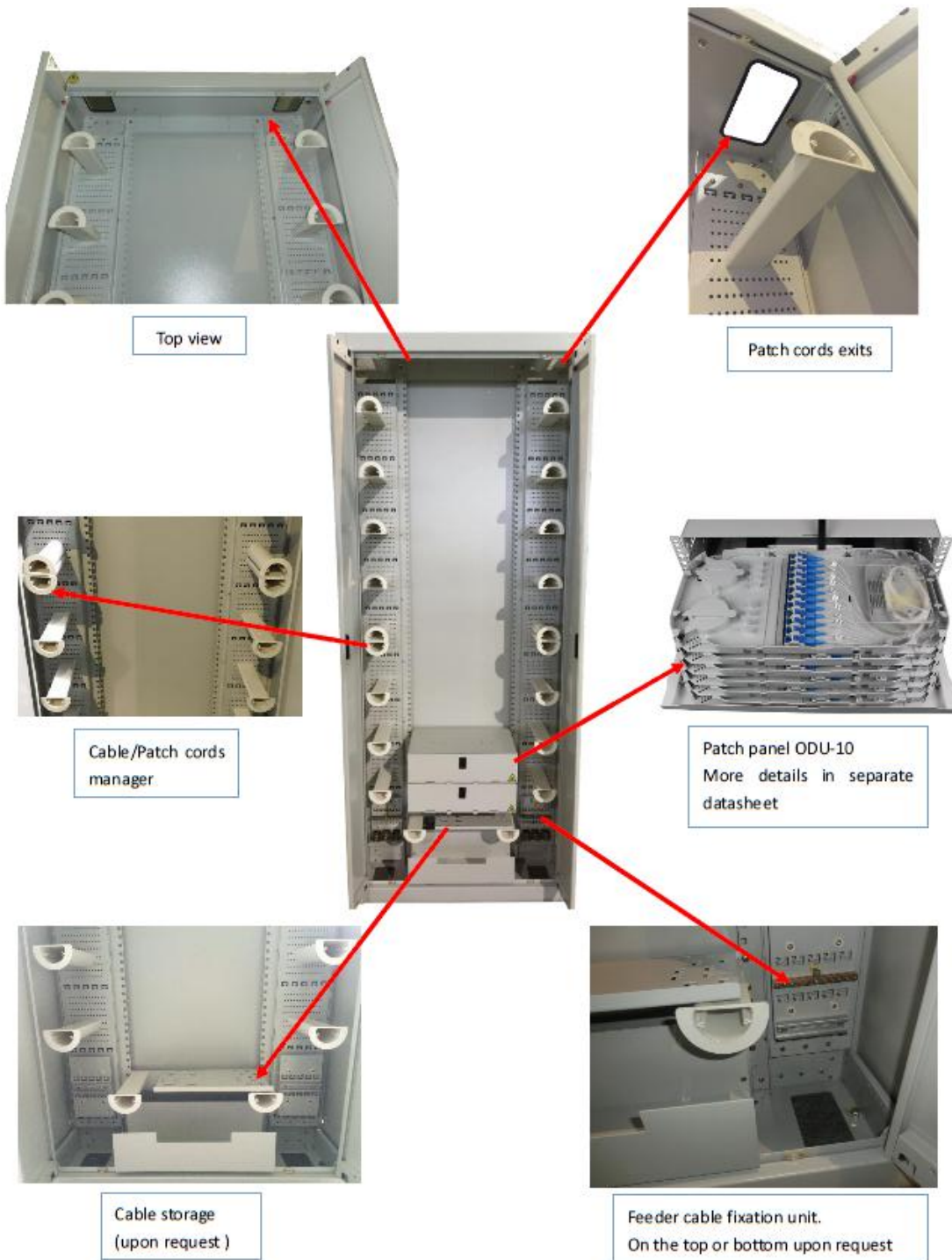

# Drawing

